

Parts

- A.** 1 x Foot Base
- B.** 4 x Uprights
- C.** 1 x Crossbeam
- D.** 1 x Support Arm

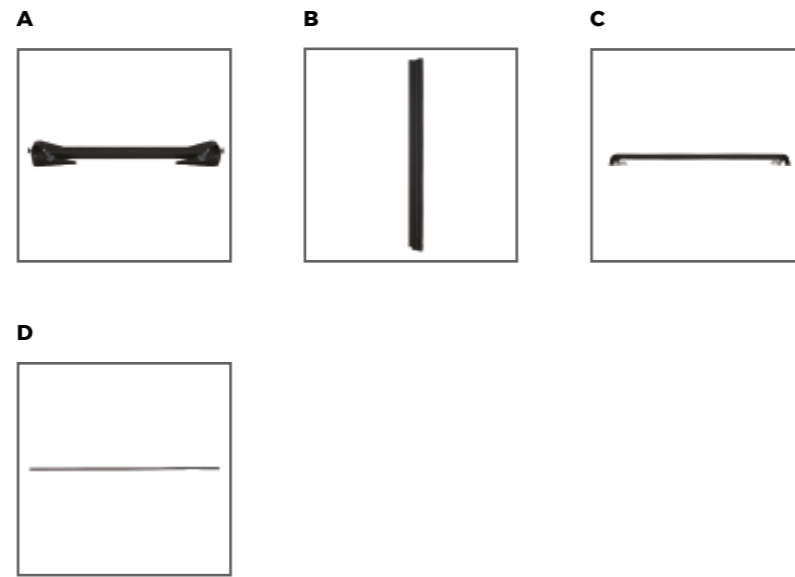

Technical Data - Fabric Display Stand Standard

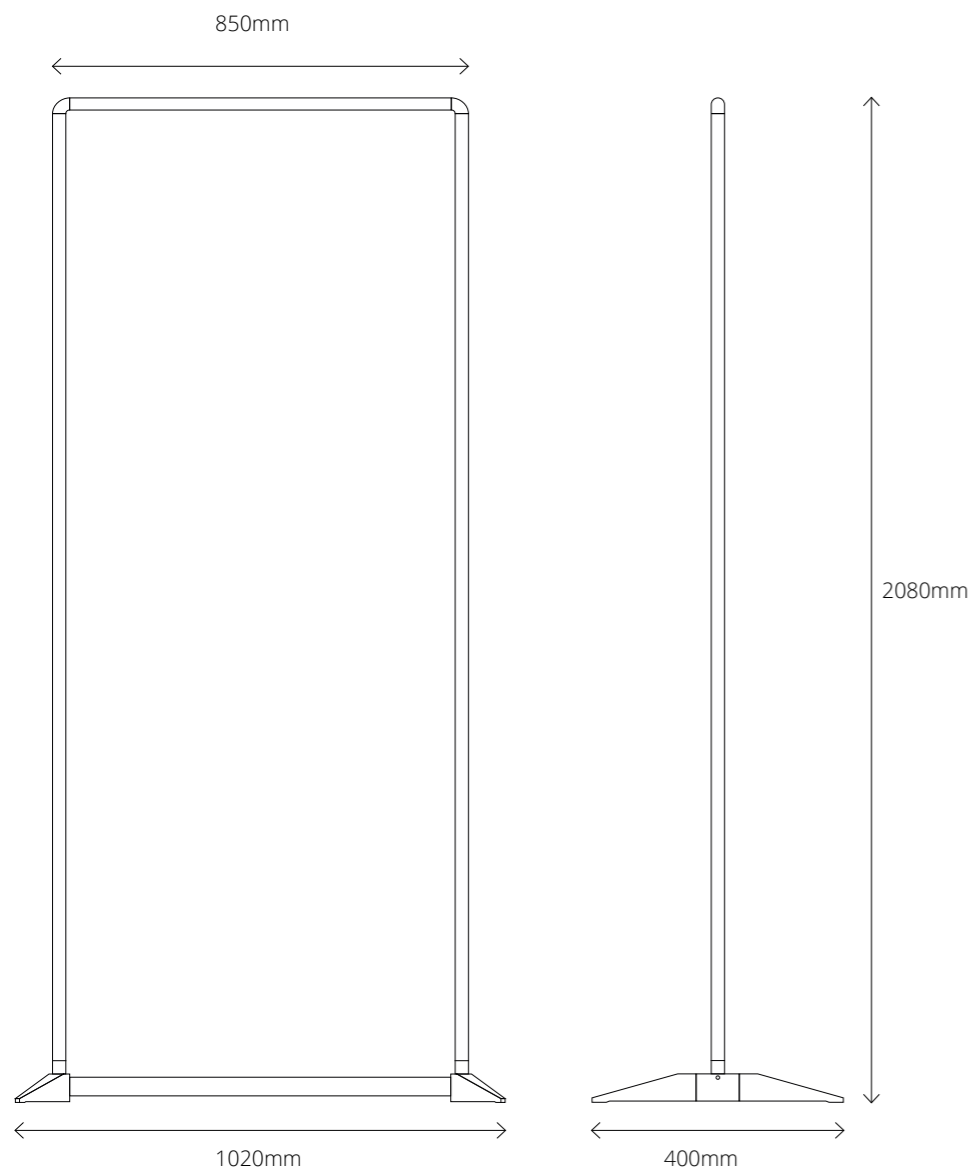

- Time Required**
< 15 mins
- People Required**
1 person
- Tools Required**
None

HARRISON
FLAGPOLES | EDS | CREATIVE

Assembly

Expand out the fold-able feet from the base.

1

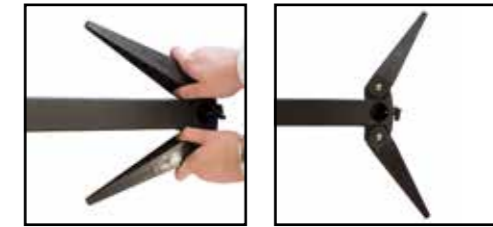

Connect all the frame sections together using the coding on each section.

2



Loosen the screw in the foot base and insert the frame into the holes. Re-tighten the screw to secure the frame.

3



Assemble the supporting arm, then stretch the frame and insert the supporting arm into the centre.

4

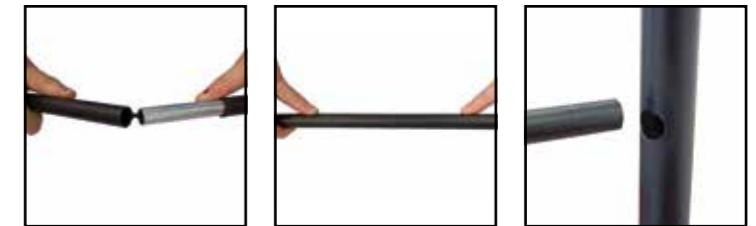

Slide the graphic down onto the frame, running your hands along each edge to rid of any creases.

5



If using the spring to load a banner, hook each eyelet of the banner onto the corresponding spring section. (Do not rotate the hook as this will make the banner crease.)

6

